

# S7607

2014-CURRENT PORSCHE  
991/911 GT3, GT3RS MUFFLER  
BY-PASS

**MBRP**  
INC.  
PERFORMANCE EXHAUST

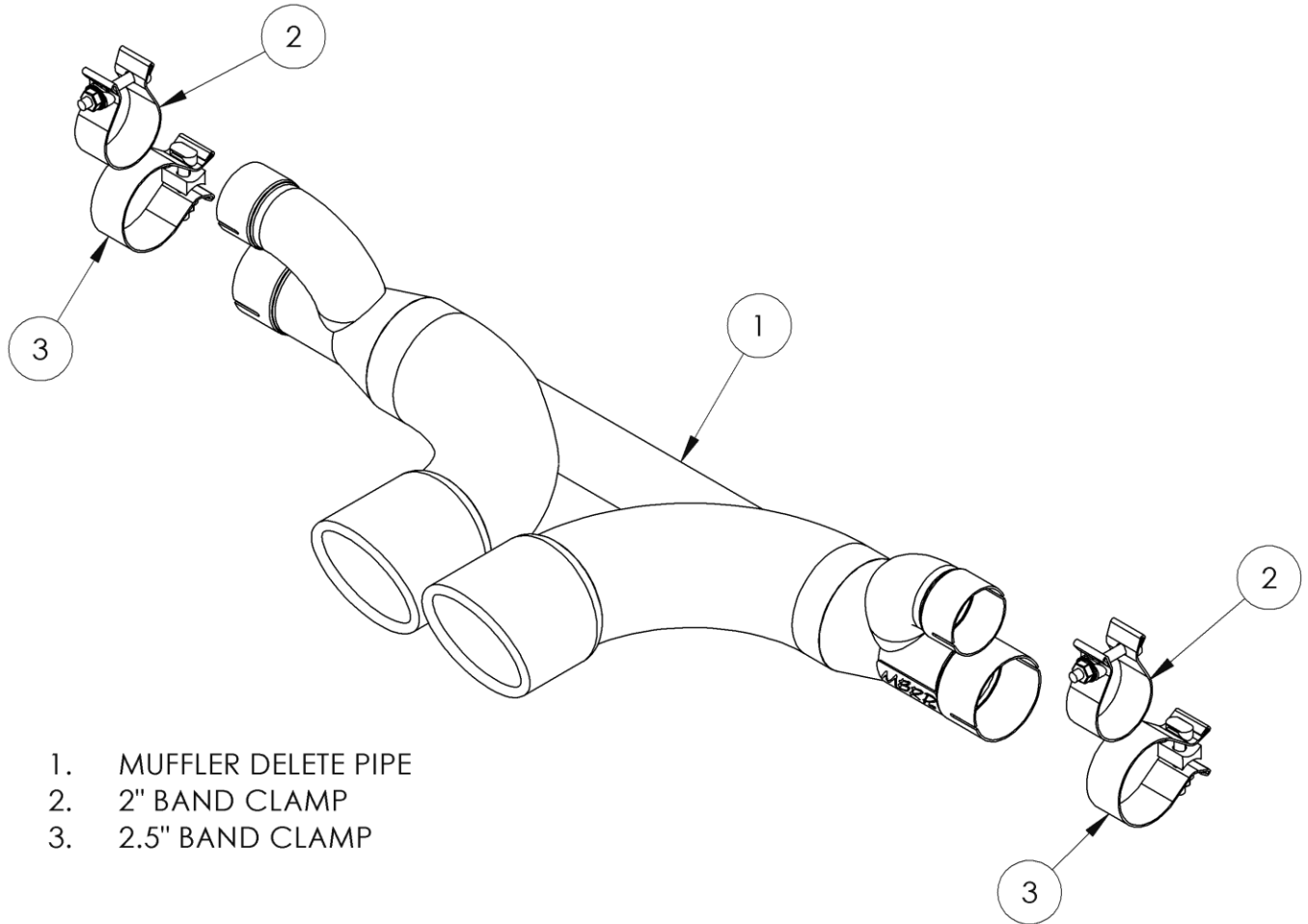

## PLEASE READ BEFORE STARTING INSTALLATION

While MBRP Inc. has made every effort to ensure that all components of this system are of superior quality and properly packaged, it is the installer's responsibility to ensure the following before removal of the factory exhaust:

- that ALL components shown above are present.
- that ALL mating components fit together.
- that there are no damaged components.
- that the system you have purchased is appropriate for your vehicle year, model and configuration.
- that the system will not interfere with any modifications previously installed or planned.
- that you have read and understand these instructions.

If you have any questions or are uncertain about any aspect of the installation of this system to your vehicle please contact your dealer before commencing installation.

**Removal of Stock System:**



**Figure 1**

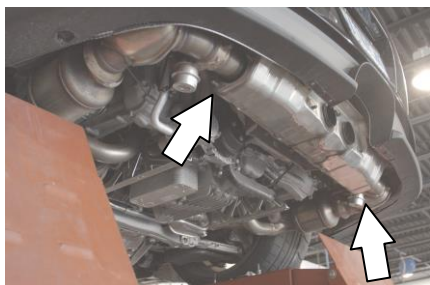

**Figure 2**

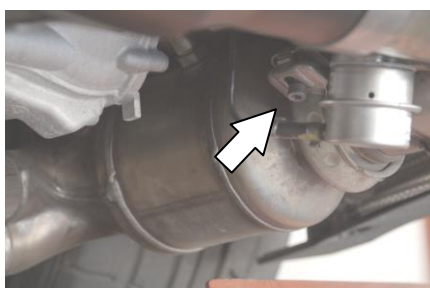

**Figure 3**



**Figure 4**



**Figure 5**

1. Apply a penetrating lubricant liberally to all threaded fasteners.
2. Remove engine under-cover.
3. Remove the factory tip assembly.  
**Refer to Figure 1.**
4. Remove the flange nuts from each of the four flanges on the stock center-muffler.  
**Refer to Figure 2.**
5. Remove the factory V-band clamps between the catalytic converters and the side-mufflers.  
**Refer to Figure 3.**
6. Remove the side-muffler mounting bracket hardware on both sides. This will allow you to push the side mufflers outward to allow removal of the center-muffler  
**Refer to Figure 4.**
7. Remove the two center-muffler mounting straps from the muffler and brackets.
8. Move the center-muffler to one side to allow the side-muffler pipes on the opposite side to be removed then tilt the muffler down and remove it from the other side.  
**Refer to Figure 5.**
9. Remove the factory gaskets and flanges from the side-mufflers.
10. **Optional** – remove the factory center-muffler mounting bracket. It is not required with the new exhaust.

**Installation of MBRP Inc. Performance Exhaust:**



**Figure 6**



**Figure 7**



**Figure 8**

1. Place one **2" Clamp** and one **2.5" Clamp** on each end of the **Muffler Delete Pipe**.  
**Refer to Figure 6.**
2. Place one end of the **Muffler Delete Pipe** onto both pipes of one of the side-mufflers. Level the **Muffler Delete Pipe** and repeat on the other side.  
**Refer to Figure 7.**
3. Ensure there is adequate insertion of the factory side-muffler pipes into the **Muffler Delete Pipe**. The factory pipes should extend past the slots in the **Muffler Delete Pipe**. Snug, but do not completely tighten the **2.5" Clamps**.
4. Level and then center the exhaust tips in the fascia opening.  
**Refer to Figure 8.**
5. Once everything is aligned, re-install the factory side-muffler mounting bracket hardware and completely tighten all **Clamps** and hardware. Check that the alignment has not changed as you tighten each part and adjust as necessary.
6. Re-install the engine under-cover.
7. Check along the whole length of the exhaust system to ensure that there is adequate clearance around the frame, body, fuel and brake lines or any wiring. If any interference is detected, relocate or adjust.



**Congratulations!** You are ready to begin experiencing the improved power, sound and driving experience of your **MBRP Inc.** performance exhaust system. We know you will enjoy your purchase.